



14 TH FLOOR

SL.NO.	NAME OF TENANTS	EXISTING CARPET AREA (SFT)	CARPET AREA PROVIDED(SFT)	SL.NO.	NAME OF TENANTS	EXISTING CARPET AREA (SFT)	CARPET AREA PROVIDED(SFT)
1401	A B HAZRA	150	152	1441	SWAPAN KR. BHADRA	79	79
1402	A. K. SIKKAR & SONS	147	148	1442	TERAPANTH MARKETING PVT.LTD	129	131
1403	SANGITA SINGH	139	140	1443	UNIVERSAL BOX STRAP & ENG.CO.	419	437
1404	ARUN BARAN DAS	55	57	1444	UPENDRA NATH DAS & ORS.	18	20
1405	ASSOCIATED CLEARING	144	148	1445	VIKASH SINGH	100	102
1406	B C PAUL & CO	65	67	1446	VISHNU SONKAR	131	132
1407	B G SOMMADAR & SONS	167	168	1447	BBWL	80	80
1408	SAJANT SINGH	225	227	15 TH FLOOR			
1409	CHANDRIMA MITRA	35	36				
1410	BIJAYA KUMAR SAHOO	190	192				
1411	DHARMENDRA SHAW & OTHERS	36	36				
1412	ESDDEE INTERNATIONAL	211	214				
1413	FASHION KRAFT & CO.	197	199				
1414	ATUL KUMAR SINGH	374	379				
1415	INDEPENDENT TRANSPORT & SHIPPING AG.	418	420				
1416	ISP TRADING CO.	168	170				
1417	JAGDAMBA ENTERPRISES	114	117				
1418	JITENDRA MISHRA	398	390				
1419	JITENDRA, SATYENDRA & HARENDRA RAI	196	210				
1420	KAMALESH SINGH & AKASH SINGH	1500	1505				
1421	LALAN SINGH AND BARAN SINGH	57	58				
1422	M K SAH (ILTY PRODUCTIONS)	219	222				
1423	M. SEAL & CO. PVT. LTD.	220	222				
1424	MADAN GOPAL STORES	213	214				
1425	MANAS KUMAR DEY	27	28				
1426	MONAMI SHIPPING AGENCYEY	155	157				
1427	MOU SHIPPING SERVICES	197	198				
1428	MIRDAL KANTI DHAR	151	152				
1429	MAKESH & NITESH KR. CHOWRASHA	13	17				
1430	NALINI BANDHU ROY	300	301				
1431	NAVNI LALL GOVIND LALL	120	120				
1432	RADHA DEVI SONKAR	27	28				
1433	RADHA MOHAN ROY	34	35				
1434	S N ROY & DIPS SINGH	134	136				
1435	EPICOME INFRA STRUCTURE PVT LTD	198	200				
1436	MICON ENGINEER	108	108				
1437	SAMSON TRADERS	151	153				
1438	SHYAMAL SARKAR	61	65				
1439	SUBAL CHANDRA DAS	35	40				
1440	SUMIT LAGRAPHIC	42	44				
1504	SHYAMAL DELIRADE	614	614				
1505	INDUSTRIAL TECHNICAL SERVICES SYND.	306	306				
1506	J. CHATTERJEE	138	138				
1507	JAGADISH PRASAD MUNDHRA	335	338				
1508	KAVITA KAPOOR	189	191				
1509	KRISHNA KUMAR THIRANI	347	346				
1510	N. SENGUPTA & CO.	117	119				
1511	BAJUNATH & SONS	286	344				
1512	PRAKASH CHANDRA AGARWAL	300	323				
1513	VIKAS CHORBARA	381	389				
1514	RAKA TEWARI	1169	1171				
1515	RAKESH KUMAR PATODIA	305	307				
1517	SANJAY KUMAR BINANI	643	640				
1517A	SANJAY KUMAR BINANI	115	115				
1518	SURESH CHANDRA JANA	56	73				
1519	TARA DEVISONKAR	13	18				
1520	TARAK NATH MULLICK	109	110				
1521	VINAY KUMAR DUBEY	629	629				
1522	VIRENDRA BARMACHA	336	338				
1523	PRAVEEN SURANA	435	441				
1524	SANJAY & SONITA BINANI	8	15				

THIS DRAWING IS A PRIVATE AND CONFIDENTIAL COMMUNICATION AND THE PROPERTY OF MANIRAMKA AND ASSOCIATES AND MUST NOT BE COPIED OR LENT WITHOUT THE CONSENT OF MANIRAMKA AND ASSOCIATES.

NOTES:
FOR SPECIFICATIONS AND DOOR & WINDOW SCHEDULE REFER DRG NO. 25.N.S.ROAD/SD/01 AND 25.N.S.ROAD/SD/02 RESPECTIVELY

DECLARATION

CERTIFICATE OF ARCHITECT

I CERTIFY WITH FULL RESPONSIBILITY THAT THE BUILDING PLAN HAS BEEN DRAWN AS PER PROVISION OF K.M.C. BUILDING RULES 2009 AS AMENDED FROM TIME TO TIME AND THE SITE CONDITION INCLUDING WIDTH OF THE ABUTTING ROAD (31.268 MT.) CONFORMS WITH THE PLAN WHICH HAS BEEN MEASURED & VERIFIED BY ME. IT IS A BUILT ABLE SITE NOT A TANK OR FILLED UP TANK. THE LAND IS DEMARCATED BY BOUNDARY WALL EXISTING STRUCTURE SHALL BE DEMOLISHED BEFORE COMMENCEMENT OF THE CONSTRUCTION WHICH IS FULLY OCCUPIED BY THE OWNER & TENANTS.

Smit Manirama
SUNIL MANIRAMKA, (B.Arch.)
Consulting Architect
Council of Architects (Reg. No. CA/03/19233)

SIG. OF ARCHITECT

CERTIFICATE OF STRUCTURAL ENGINEER

THE STRUCTURAL DESIGN & DRAWING OF THE BOTH FOUNDATION AND SUPER STRUCTURE OF THE BUILDING HAS BEEN MADE BY ME CONSIDERING ALL THE POSSIBLE LOADS INCLUDING SEISMIC LOAD AS PER THE NATIONAL BUILDING CODE OF INDIA AND CERTIFY THAT IT IS SAFE, STABLE IN ALL RESPECT. SOIL TESTING REPORT HAS BEEN DONE BY SKM GEOSURVEY, BK-130, SALLAKE, KOLKATA-700091. THE RECOMMENDATION OF REPORT HAS BEEN CONSIDERED DURING STRUCTURAL CALCULATION.

Sanjay Parekh
SANJAY PAREKH
M.E. (STRUCT.), M.E. (CONSTRNG.)
R.C.E. FILE-F-818202-3
E.S.E. No. 184 (I) K.M.C.

SIG. OF STR. ENGINEER

CERTIFICATE OF STRUCTURAL REVIEWER

THIS IS TO CERTIFY THAT I HAVE REVIEWED THE STRUCTURAL DESIGN OF PROPOSED PREMISES CONSIDERING ALL POSSIBLE LOADS INCLUDING SEISMIC LOAD AS PER PROVISION OF RELEVANT IS CODE. AND IT IS ALSO CERTIFIED THAT THE BUILDING IS SAFE AND STABLE IN ALL RESPECT.

Sanjib Guha
SANJIB GUHA
BSC, BCE, FIE-(F-115654-5)
CHARTERED ENGINEER
ENLISTED STRUCTURAL
REVIEWER 88/16 K.M.C.

SIG. OF STR. REVIEWER

CERTIFICATE OF THE GEO-TECHNICAL ENGINEER

IT IS CERTIFIED THAT THE COMPREHENSIVE GEO-TECHNICAL REPORT ON SOIL INVESTIGATION HAS BEEN PREPARED BY ME FOR DESIGN AND CALCULATION OF THE FOUNDATION BY ANALYZING THE SOIL SAMPLE FOR ESTIMATING THE BEARING CAPACITY OF THE SOIL ON WHICH FOUNDATION OF THE STRUCTURE WILL BE CONSTRUCTED. I SHALL ALSO CHECK THE NATURE OF THE SOIL AFTER EXCAVATION AT SITE SO THAT FOUNDATION IS EXTENDED UP TO APPROPRIATE DEPTH THAT HAS BEEN PROPOSED IN THE GEO-TECHNICAL REPORT.

Jishnu Pal
JISHNU PAL
B.Tech (Civil), M.E. (Gen Tech)
K.M.C. Reg. No. G.T/1/32
GTSE/NDAJ/10/04/6
22/BARON (G.T.1/2016-17
HMC Reg. No. EGTR/CLASS-1/15

SIG. OF GEO-TECHNICAL ENGINEER

CERTIFICATE OF OWNER

WE DO HEREBY UNDERTAKE WITH FULL RESPONSIBILITY THAT -
1) WE SHALL ENGAGE L.B.A. & E.S.E DURING CONSTRUCTION.
2) WE SHALL FOLLOW THE INSTRUCTION OF L.B.A. & E.S.E DURING CONSTRUCTION OF THE BUILDING (AS PER B.S.PLAN)
3) K.M.C. AUTHORITY WILL NOT BE RESPONSIBLE FOR STRUCTURAL STABILITY OF THE BUILDING & ADJOINING STRUCTURE.
4) IF ANY SUBMITTED DOCUMENTS ARE FOUND TO BE FAKE, THE K.M.C. AUTHORITY WILL REVOKE THE SANCTION PLAN.
5) THE CONSTRUCTION OF WATER RESERVOIR AND SEPTIC TANK WILL BE UNDER THE GUIDANCE OF L.B.A. / E.S.E BEFORE STARTING OF BUILDING FOUNDATION WORK.

For Bengal Bonded Warehouse Limited
[Signature]
Director

SIG. OF OWNER

PLAN OF PROPOSED G+32 (127.200 MT HT.) STORED 'MEGA COMMERCIAL PROJECT' AT PREMISES NO: 25, NETAJI SUBHAS ROAD, WARD NO - 45, BOROUGH -V, P.S. - HARE STREET, KOLKATA - 700001 KOLKATA MUNICIPAL CORPORATION. AS PER SECTION 412A OF KOLKATA MUNICIPAL CORPORATION ACT 1980

SANCTION DRAWING

14TH & 15TH FLOOR PLAN OF NORTH TOWER

STRUCTURAL ENGINEER : SPA CONSULTANTS (SPA)
34 RAMMOHAN DUTTA ROAD, KOLKATA-700020
WEST BENGAL, INDIA
Email: spa_cons@yahoo.co.in

DATE: 20.07.2023 SCALE: 1:100 DEALT: MAHUA/RUCHIRA DRG.NO:25.N.S.ROAD/SD/13

ARCHITECTS : MANIRAMKA AND ASSOCIATES
74 B, A. J. C. ROSE ROAD, KOLKATA-700 016
PHONE : (033) 2217 8329
Email: maniramka.associates@gmail.com
www.maniramkaarchitect.com

SHEET = 13 OF 26

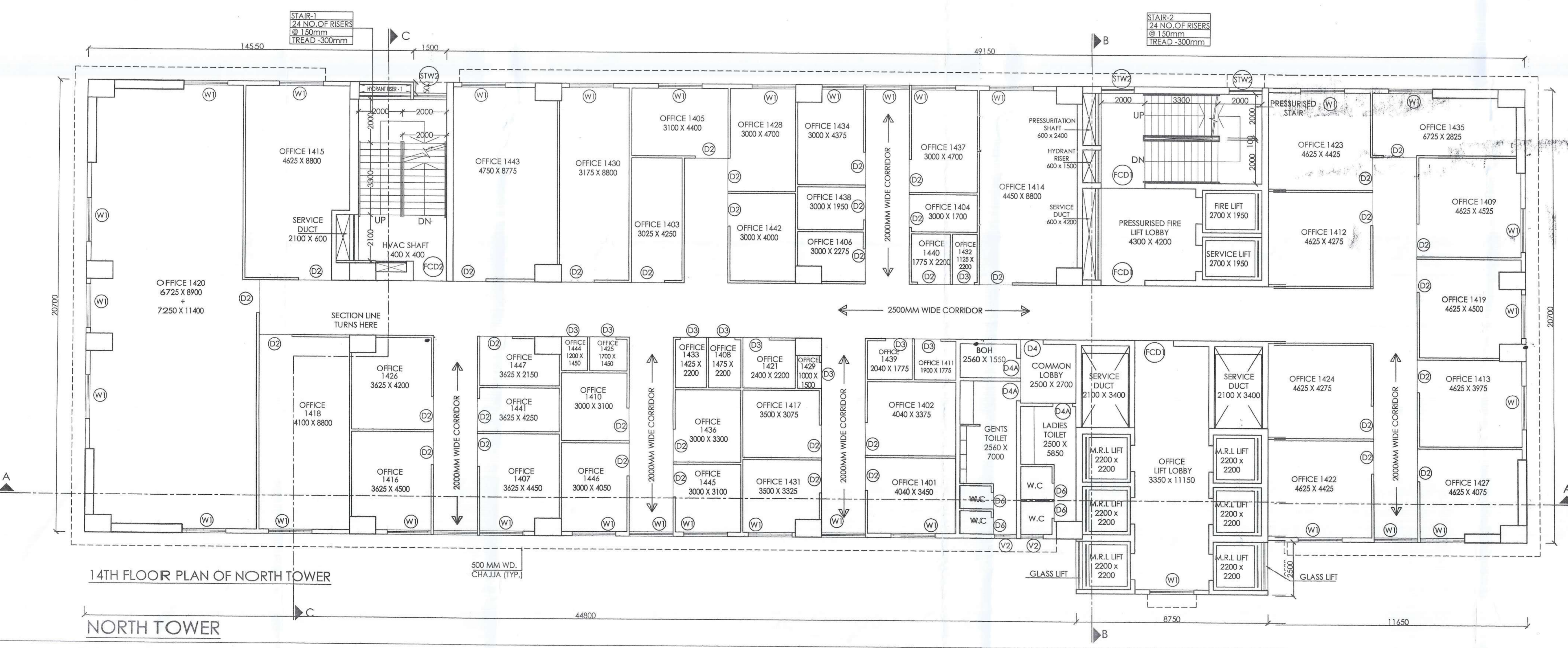
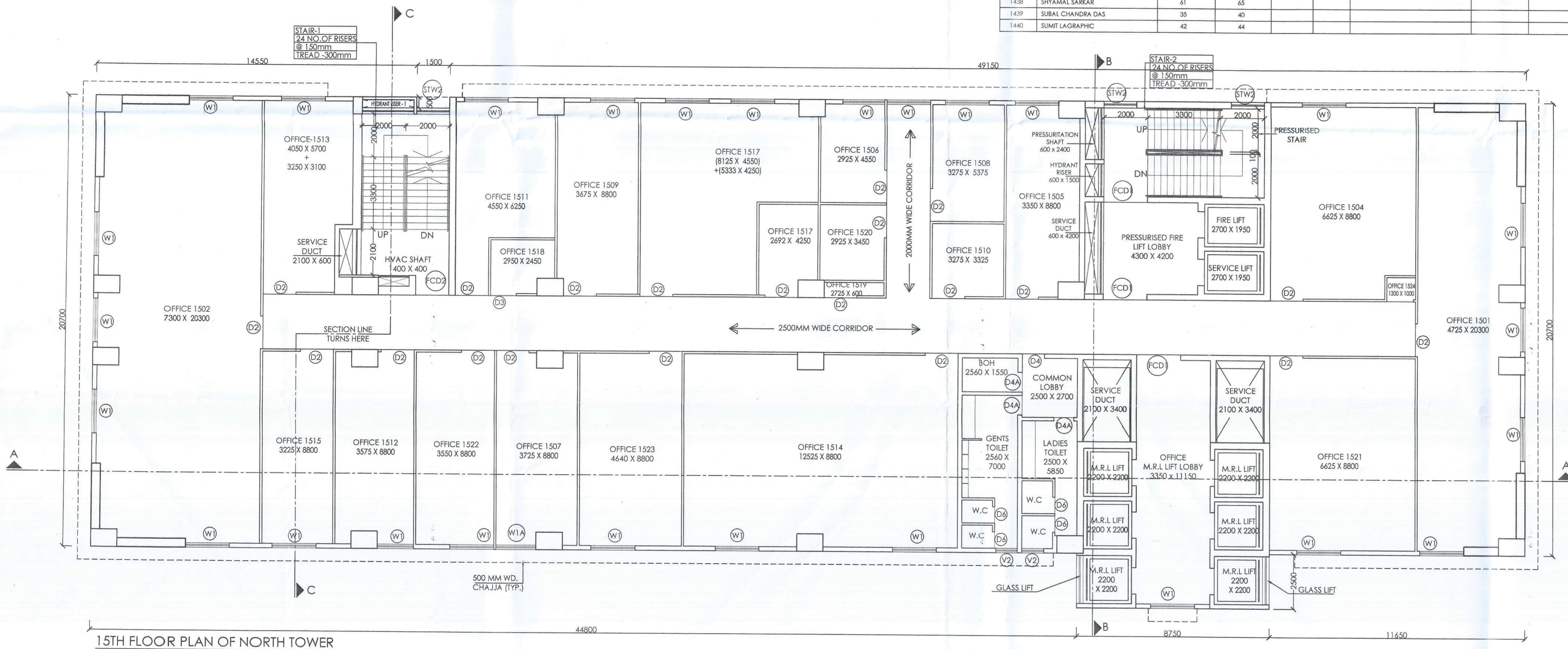

NORTH TOWER

PARTY'S COPY

Plan for Water Supply arrangement including SEMLI, C & O, H, reservoir should be submitted at the Office of the Executive Engineer and the sanction obtained before proceeding with the work of Water Supply any deviation may lead to disconnection/dismantment.

Before starting any Construction the site must conform with the plans sanctioned and all the conditions as proposed in the plan should be fulfilled.

The validity of the within permission to execute the work is subject to the above conditions.

The sanction refers to the proposed portion shown in red and the Executive Engineers makes no admission as to the correctness of the plan.

Design of all Structural Members including that of the foundations should conform to Standards specified in the National Building Code of India.

CONSTRUCTION SITE SHALL BE MAINTAINED TO PREVENT MOSQUITO BREEDING AS REQUIRED DIS 498 (1) & (2) OF O.M.C. ACT 1980. IN SUCH MANNER SO THAT ALL WATER COLLECTION & PARTICULARLY LIFT WELLS, WAYS, EMERGENT CURBED STREETS, OPEN RECEPACLES ETC. MUST BE EMPTIED COMPLETELY TWICE A WEEK.

Design of all Structural Members including that of the foundations should conform to Standards specified in the National Building Code of India.

CONSTRUCTION SITE SHALL BE MAINTAINED TO PREVENT MOSQUITO BREEDING AS REQUIRED DIS 498 (1) & (2) OF O.M.C. ACT 1980. IN SUCH MANNER SO THAT ALL WATER COLLECTION & PARTICULARLY LIFT WELLS, WAYS, EMERGENT CURBED STREETS, OPEN RECEPACLES ETC. MUST BE EMPTIED COMPLETELY TWICE A WEEK.

The building materials that will be stacked on Road/Passage or Foot-path beyond 3-months or after construction of 6 Floor, whenever its water may be seized forthwith by the K.M.C. at the cost and risk of the owner.

No rain water pipe should be laid or discharged on Road or Footpath.

Drainage plan should be submitted at the Office of the Executive Engineer and the sanction obtained before proceeding with the drainage work.

A suitable pump has to be provided i.e. pumping untreated water for the distribution to the building and water from street building rising drains and urinals in the main is not available.

Non Completion of Erection/Re-Erection within five years will Require Fresh Application for Sanction.

BUSINESS BUILDING

THE SANCTION IS VALID UP TO 30-07-2025

DEMANTION WOULD BEAN DEMANTION

Necessary stops should be taken for the safety of the lives of the adjoining public and private properties during construction.

Approved By **Public Health Officer** 6/9 29/12/24
The Building Committee

